

Cell Culture Plate (6 Well)

(#30006/31006/32006)

1. Applications

Multiwell Plates have been widely used for handling different samples in single experiment during culture. SPL Life Sciences provides a wide option of multiwell plates from 4-well to 96-well plates. All of the multiwell plates were tested for cell culture. Optically clear high quality polymers were used during production. Sterile versions of multiwell plates are treated with Gamma irradiation after complete packaging to eliminate any chance for possible exposures to contamination sources. Surface treated or non-treated version can be selected for each multiwell plate depending on the experiments

2. Features

- ❖ Designed to prevent cross contamination
- ❖ Packed individually
- ❖ Optically clear and uniform surface for microscopy
- ❖ Crystal-grade polystyrene (PS)
- ❖ Non - sterilized (Cat.No. 31006)
- ❖ Non - treated plates (Cat.No. 32006)
- ❖ Flat Bottom
- ❖ Sterilized
- ❖ Non-pyrogenic
- ❖ Non-cytotoxic
- ❖ Complied with USP guideline (USP class VI tested)
- ❖ Complied with ANSI guideline

3. Functional Test

Sterility	:	Passed
Cytotoxicity	:	Passed
Non-Pyrogenic	:	Passed

4. Product Range

Cat.No.	Bottom Type	External Dimension (mm)	Well Dimension (mm)	Growth Area (cm ²)	Working Volume (ml)	Surface Treatment	Sterilized	Units per Sleeve/Case
30006	Flat	85.4 x 127.6	35	9.6	3	+	+	1 / 50
31006	Flat	85.4 x 127.6	35	9.6	3	-	-	1 / 50
32006	Flat	85.4 x 127.6	35	9.6	3	-	+	1 / 50

5. ISO 9000 Certification

SPL Life Sciences hereby certifies that the product identified above, inspected to be in compliance with product quality specification and requirements as documented in our ISO 9001:2008 Quality Management System (K-QA-Q031478) in Korea.

6. Specifications & Technical Drawing

- Specifications

Dimensions		Material (Resin)	Packaging
Lid	Dish		
Length: 127.10 mm	Length: 127.60 mm	Crystal-grade polystyrene (PS)	<ul style="list-style-type: none"> • Pieces/Sleeve: 1 • Pieces/Case: 50
Width: 84.90 mm	Width: 85.40 mm		
Height: 10.00 mm	Height: 20.20 mm		
	Well Dimension: 35.00 mm		
Volume per Well: 3.00 ml			
Growth Area: 9.60 cm ²			

- Technical Drawing

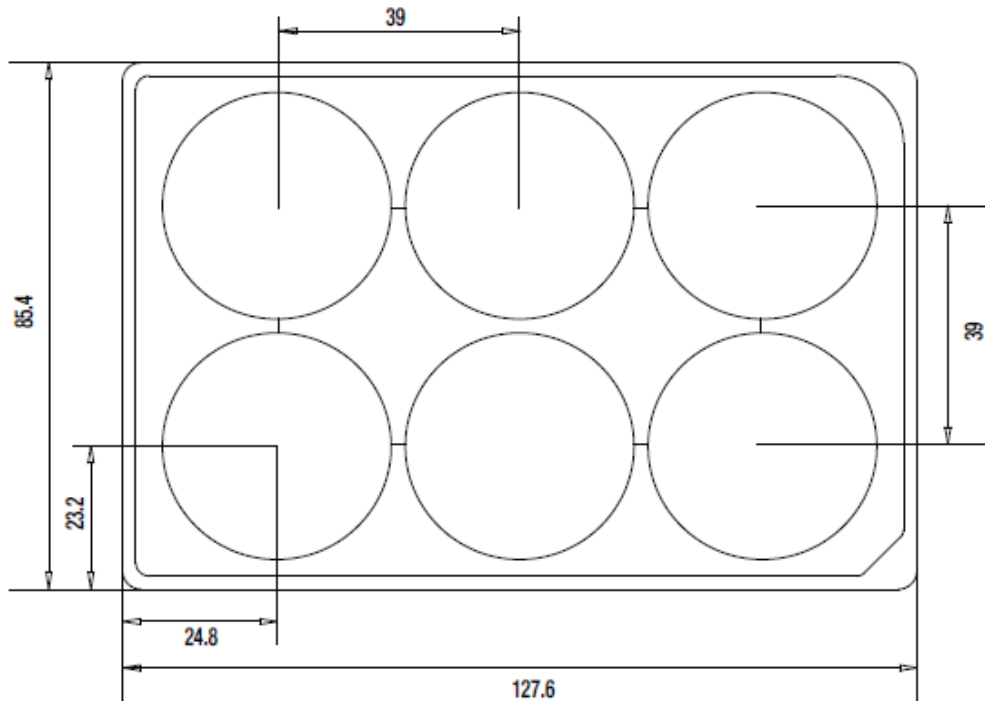

www.spllifesciences.com

For technical assistance, contact SPL R&D Center at:

Tel: +82-31-533-4800; Fax: +82-31-533-1430; e-mail: spl@ispl.co.kr

To place an order, contact your local distributor or

Tel: +82-31-533-4800; Fax: +82-31-533-1430; e-mail: business@ispl.co.kr